

RAMS

4600 Highway 183 Alternate
 Hays, KS 67601
 (785) 625-6346
 Fax (785) 625-2795

Assembly Alert: 164

Date: January 14, 2008

Subject: Parts missing from S-19 Empennage Kits

Compliance: Mandatory

Models Affected: S-19 Empennage Kits shipped before January 14, 2008.

It has come to our attention that parts were left out of the S-19 Empennage Kit.

Below is a list of the parts and corresponding parts pages which are shipping with this Assembly Alert.

<u>Parts Page</u>	<u>Description</u>	<u>Part Number</u>	<u>Quantity</u>
02B-02	1/8" Stainless Steel Rivet – Cherry Q	CCPQ-42	52
02B-02	3/16" Bolt	AN3-5A	4
02B-02	3/16" Shear Nut	AN364-1032A	4
02B-02	3/16" Thin Washer	AN960-10L	4
02B-06	Stabilator hinge Support - Inner	KPHS0048	1
02B-06	Stabilator hinge Support - Outer	KPHS0049	2
02B-06	1/8" Stainless Steel Rivet – Cherry Q	CCPQ-41	6
02C-02	#8 Single-Ear Nut Plate	MS21051-08	4
02C-02	3/32" Aluminum Rivet	40APR1/8	8

Thank you for your attention to this matter. I hope that we have not inconvenienced you to any great degree. Fly safe!

#	DESCRIPTION	PART NUMBER	QUANTITY
1.	Stabilator Rib - #4, 5 & 6	KPHS0050	6
2.	Stabilator Rib - #2 & 3	KPHS0051	4
3.	Stabilator Spar - Angle	KPHS0043	2
4.	Stabilator Spar	KPHS0042	1
5.	1/8" Aluminum Rivet - Cherry Q	AAPQ-42	18
5.	1/8" Aluminum Rivet - Cherry Q	AAPQ-42	18
6.	Stabilator - Nose Rib	KPHS0052	12
7.	1/8" Stainless Steel Rivet - Cherry Q	CCPQ-42	64
8.	Stabilator - Plate	KPHS0055	1
9.	Angle Stabilator Hinge	KPHS0058	4
10.	1/8" Stainless Steel Rivet - Cherry Q	CCPQ-44	8
11.	3/16" Bolt	AN3-5A	8
12.	3/16" Shear Nut	AN364-1032A	8
13.	3/16" Thin Washer	AN960-10L	8
14.	Stabilator Spar - Bar	KPHS0044	2
15.	Stabilator Jig	KPHS0067-1	1
16.	Stabilator Jig	KPHS0067-2	1
17.	Stabilator Jig	KPHS0067-3	6
18.	Stabilator Jig	KPHS0067-4	2
19.	Stabilator Jig - Spacer Block	KPHS0067-5	2
20.	Stabilator Jig - Spacer Block	KPHS0067-6	2
21.	Stabilator Jig - Spacer Block	KPHS0067-7	2
22.	Stabilator Jig - Spacer Block	KPHS0067-8	4
23.	Joggle Tool	KPAC0202	1
24.	Stabilator Jig - Angle	KPHS0068	2

NOTE: ORIENTATE PRE-DRILLED
SPAR HOLES UPWARD

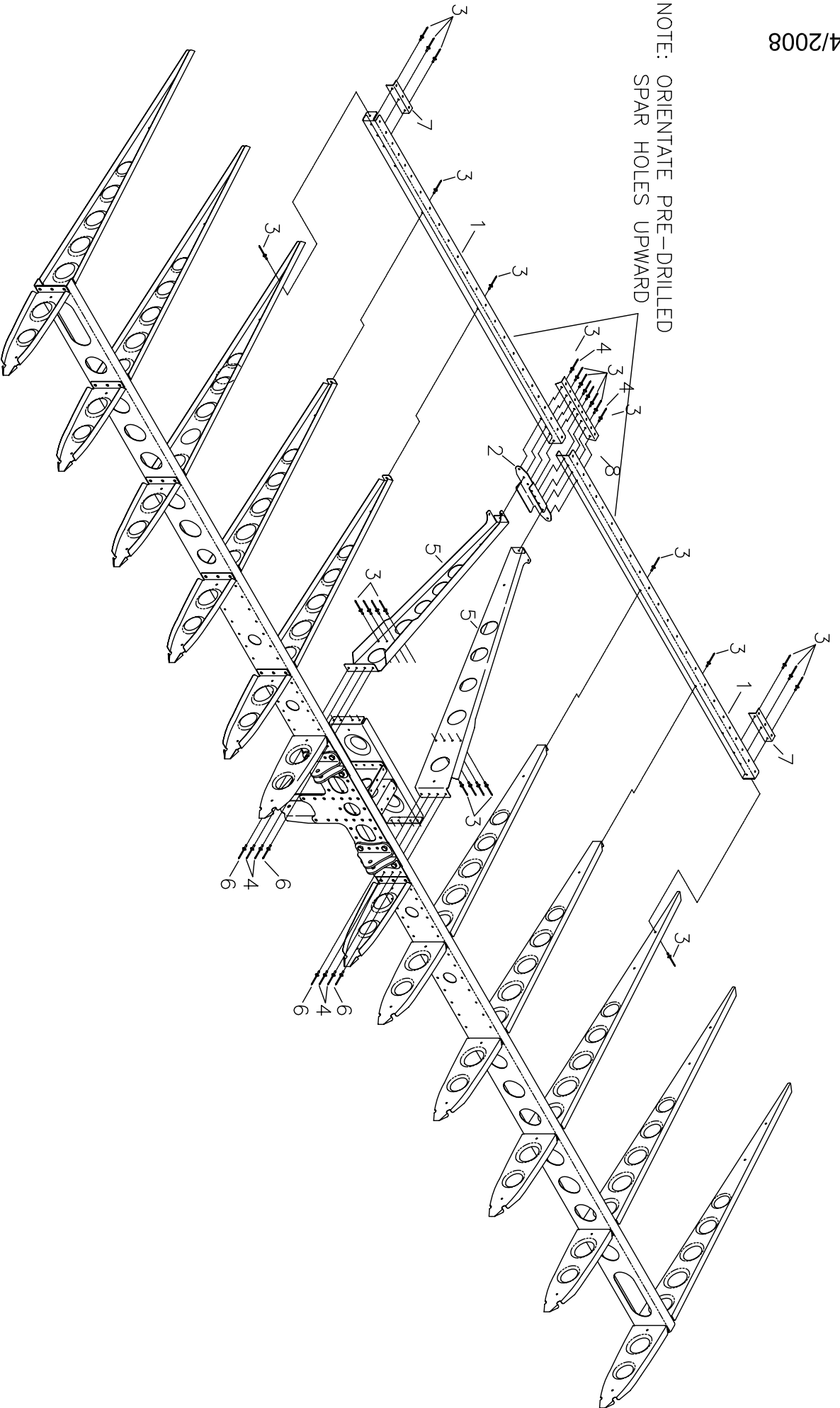

RRPND83 S-19
STABILATOR FRAME ASSEMBLY #3

MD4781
 REV. A

#	DESCRIPTION	PART NUMBER	QUANTITY
1.	Stabilator - Rear Spar - RH	KPHS0045-R	1
1.	Stabilator - Rear Spar - LH	KPHS0045-L	1
2.	Rear Channel Splice	KPHS0047	1
3.	1/8" Stainless Steel Rivet - Cherry Q	CCPQ-41	26
4.	1/8" Stainless Steel Rivet - Cherry Q	CCPQ-42	6
5.	Stabilator Rib - #1	KPHS0054	2
6.	1/8" Stainless Steel Rivet - Cherry Q	CCPQ-43	4
7.	Stabilator Hinge Support - Outer	KPHS0049	2
8.	Stabilator Hinge Support - Inner	KPHS0048	1

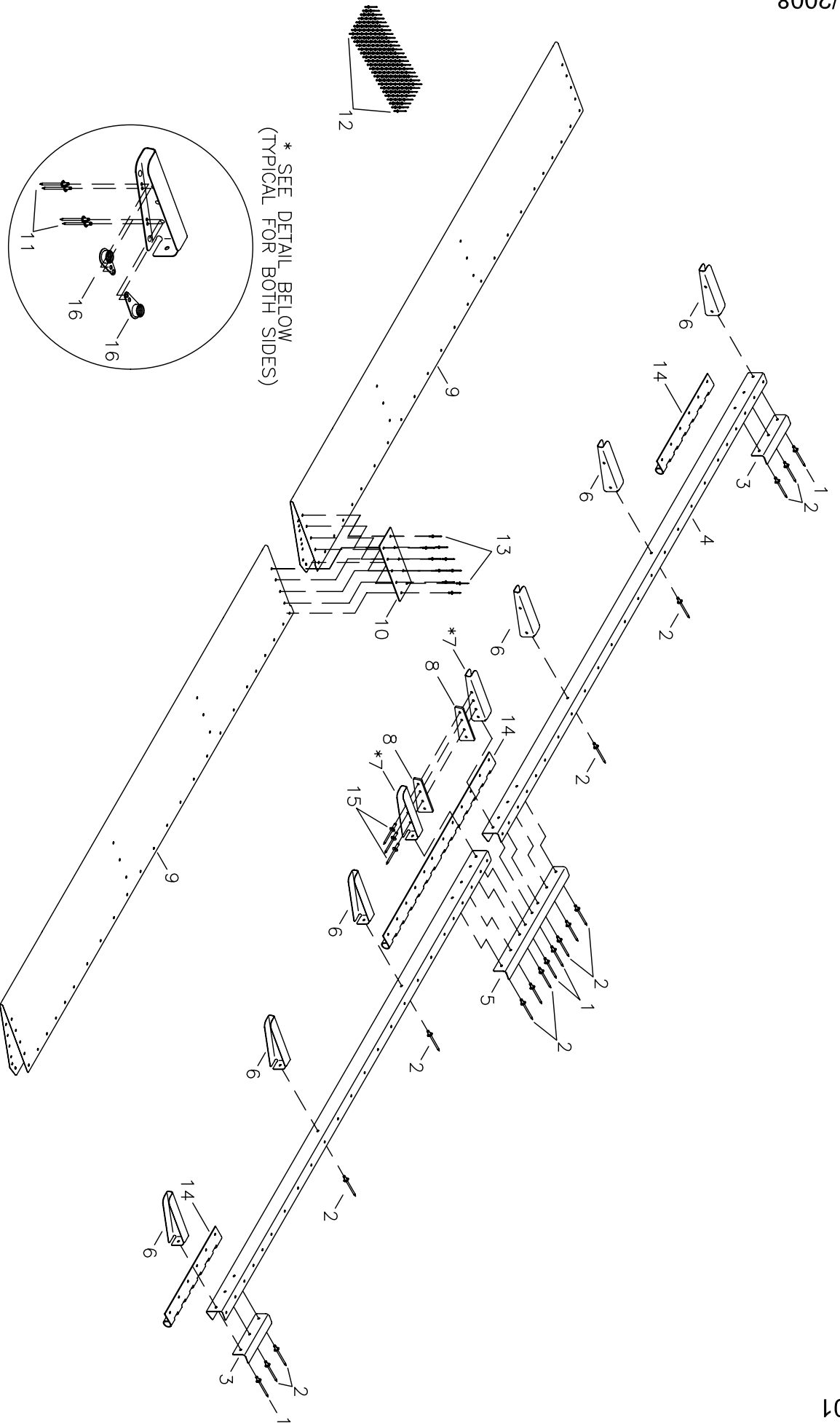

RFD S-19
ANTI-SERVO/TRIM TAB ASSEMBLY

MDS011
 REV. A

#	DESCRIPTION	PART NUMBER	QUANTITY
1.	1/8" Aluminum Rivet - Cherry Q	AAPQ-42	4
2.	1/8" Aluminum Rivet - Cherry Q	AAPQ-41	14
3.	Trim Tab Hinge Support	KPTR0037	2
4.	Trim Tab Spar - RH	KPTR0033-R	1
4.	Trim Tab Spar - LH	KPTR0033-L	1
5.	Trim Tab Hinge Support	KPTR0036	1
6.	Trim Tab Rib - RH	KPTR0032-R	3
6.	Trim Tab Rib - LH	KPTR0032-L	3
7.	Trim Tab Rib - RH	KPTR0034-R	1
7.	Trim Tab Rib - LH	KPTR0034-L	1
8.	Spacer Plate *	KPTR0040	1
9.	Trim Tab Skin - LH	KPTR0035-L	1
9.	Trim Tab Skin - RH	KPTR0035-R	1
10.	Tab Joiner	KPTR0038	1
11.	3/32" Aluminum Rivet	40APR1/8	8
12.	1/8" Aluminum Rivet - Avex	1691-0410	160
13.	1/8" Stainless Steel Rivet - Cherry Q	CCPQ-42	10
14.	1-1/4" x .040 Hinge *	MS20257-3	0
15.	1/8" Aluminum Rivet - Cherry Q	AAPQ-45	3
16.	#8 Single-Ear Nut Plate	MS21051-08	4

*Builder Modifies

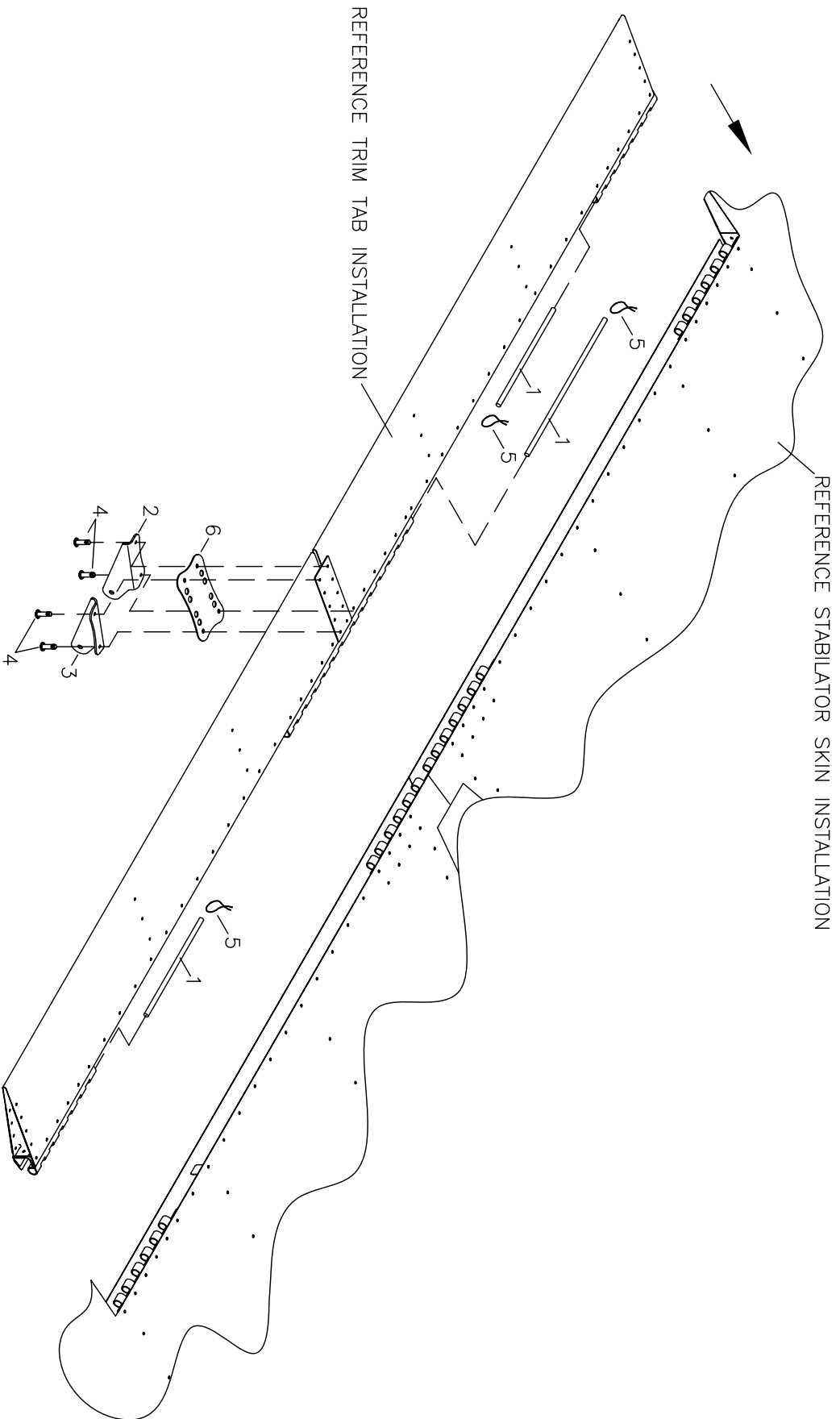

RRRMD08 S-19
ANTI-SERVO/TRIM TAB INSTALLATION

MD5012

#	DESCRIPTION	PART NUMBER	QUANTITY
1.	1-1/4 Hinge Pin	MS20257-3	0
2.	Trim Tab Horn - LH	KPTR0046-L	1
3.	Trim Tab Horn - RH	KPTR0046-R	1
4.	#8 Trusshead Screw	AN526-832R6	4
5.	Safety Wire	-----	0
6.	Spacer Plate	KPTR0039	1